

**25A HIGH CURRENT GLASS PASSIVATED SINGLE_PHASE
BRIDGE RECTIFIFR**

Reverse Voltage - 200 to 1000 V

Forward Current – 25 A

FEATURES

- ✦ The plastic package has Underwriters Laboratory flammability recognition 94V-0
- ✦ Integrally molded heatsink provide very low thermal resistance for maximum heat dissipation
- ✦ Universal 3_way terminals; snap_on, wire wrap _around, or P.C. Board mounting
- ✦ Surge overload ratings to 400 Amperes
- ✦ Glass passivated chip junctions
- ✦ High temperature soldering guaranteed: 260°C/10 seconds at 5lbs., (2.3kg)tension

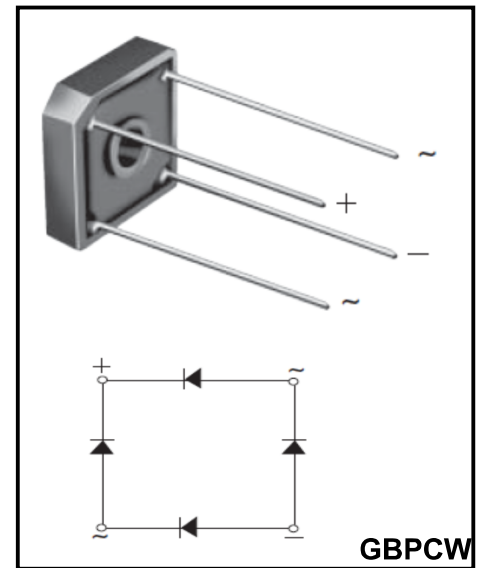

MECHANICAL DATA

- ✦ MECHANICAL DATA Terminals:Nickelplaed.25 " (6.35mm) Faston lugs
- ✦ Mounting position: Bolt doen on heat_sink with Silicone thermal compound between bridge and Mounting surface for maximum heat transfer efficiency. with number 5 screw
- ✦ polarity: polarity symbols molded on body
- ✦ Weight: 12 grams

Maximum Ratings and Electrical characteristics

Ratings at 25 °C ambient temperature unless otherwise specified.

Parameter	Symbols	GBPC 2502W	GBPC 2504W	GBPC 2506W	GBPC 2508W	GBPC 2510W	Units
Maximum Repetitive Peak Reverse Voltage	V_{RRM}	200	400	600	800	1000	V
Maximum RMS voltage	V_{RWM}	140	280	420	560	700	V
Maximum DC Blocking Voltage	V_{RMS}	200	400	600	800	1000	V
Average rectified forward current (50Hz Sine wave resistance load $T_c=85^{\circ}C$)	I_o	25					A
Peak Surge forward Current (Non-repetitive 50Hz 10ms Sine wave $T_j=25^{\circ}C$)	I_{FSM}	400					A
Dielectric strength (Terminals to case AC 1 minute)	V_{dia}	2					KV
Forward Voltage per element @ $I_F=12.5A$ and $25^{\circ}C$	V_F	1.05					V
Reverse current($V_R=V_{RM}$)	I_R	10					μA
Thermal reslstance(Junction to Case)	Q_{Jc}	1.5					$^{\circ}C/W$
Operating and Storage Temperature Range	T_j, T_{stg}	-40 ~ 150					$^{\circ}C$

Rating and Characteristic Curves

FIG1: I_o - T_c Curve

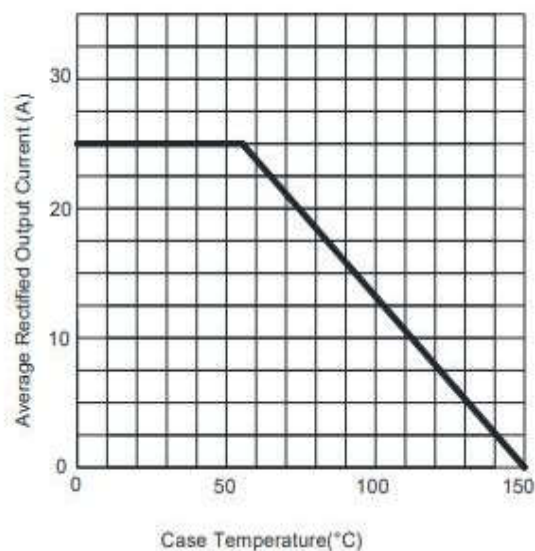

FIG2: Surge Forward Current Capability

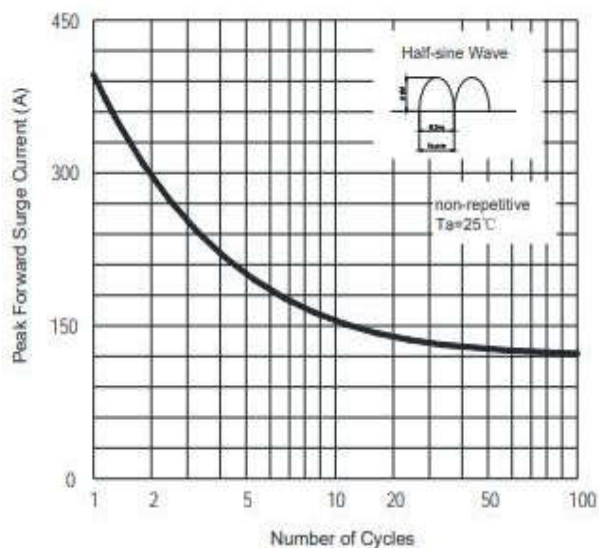

FIG3: Instantaneous Forward Voltage

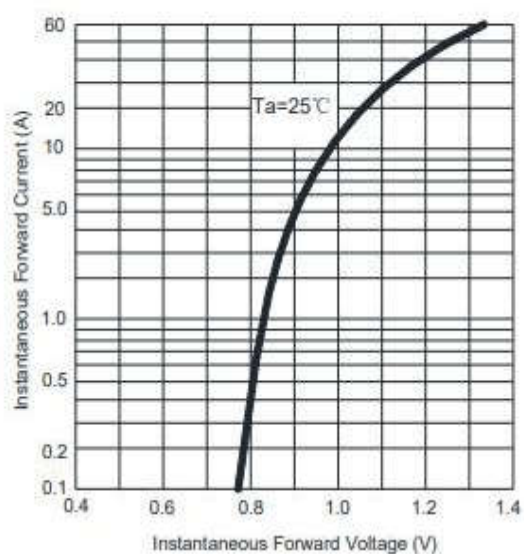
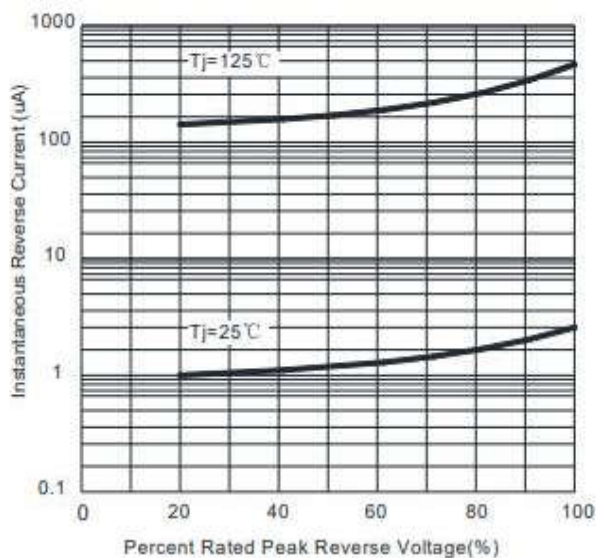
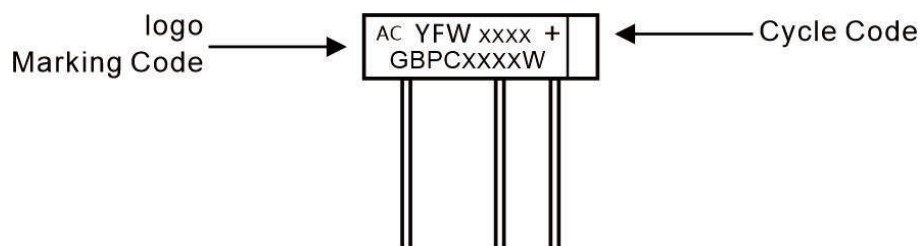

FIG4: Typical Reverse Characteristics



Marking Diagram



Ordering information

Package	Packing Description	Packing Quantity
GBPCW	bulk	50PCS/Box 500PCS/Carton

Package Dimensions

GBPCW

Dim.	Millimeter(mm)		DimensionsinInch	
	Min.	Max.	Min.	Max.
A	28.2	28.8	1.11	1.13
B	17.1	19.1	0.67	0.75
C	10.4	12.4	0.41	0.49
D	0.95	1.05	0.04	0.04
E	7.6	8.2	0.30	0.32
F	30	/	1.18	/

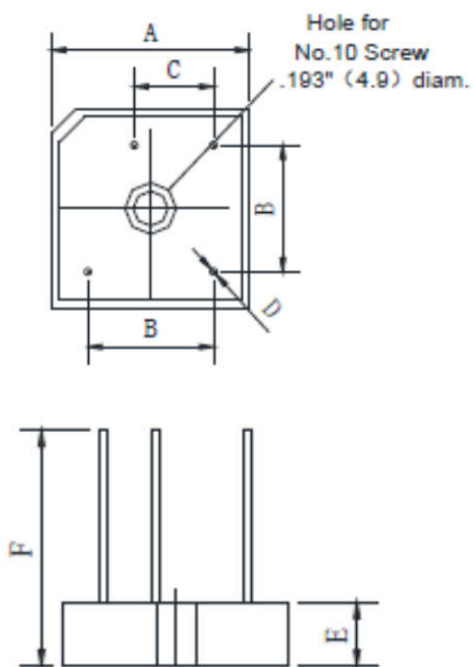

Disclaimer

The information presented in this document is for reference only. GuangDong Youfeng Microelectronics Co.,Ltd. reserves the right to make changes without notice for the specification of the products displayed herein to improve reliability, function or design or otherwise. The product listed herein is designed to be used with ordinary electronic equipment or devices, and not designed to be used with equipment or devices which require high level of reliability and the malfunction of which would directly endanger human life (such as medical instruments, transportation equipment, aerospace machinery, nuclear-reactor controllers, fuel controllers and other safety devices), YFW or anyone on its behalf, assumes no responsibility or liability for any damages resulting from such improper use of sale. This publication supersedes & replaces all information previously supplied. For additional information, please visit our website <https://www.yfwdiode.com>, or consult YFW sales office for further assistance.